

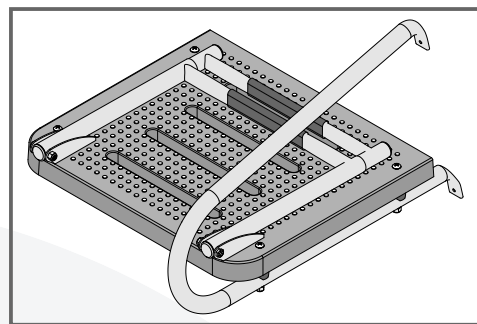

# Swim Platform

Assembly & Installation Guide  
WB.SP.03

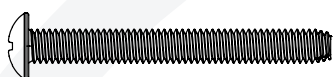

## HARDWARE REQUIRED

B1  x3

N1  x4

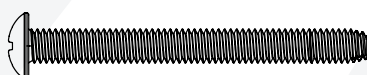
B2  x1

## TOOLS REQUIRED



7/16" Wrench x2

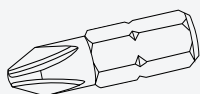

#3 Phillips Bit

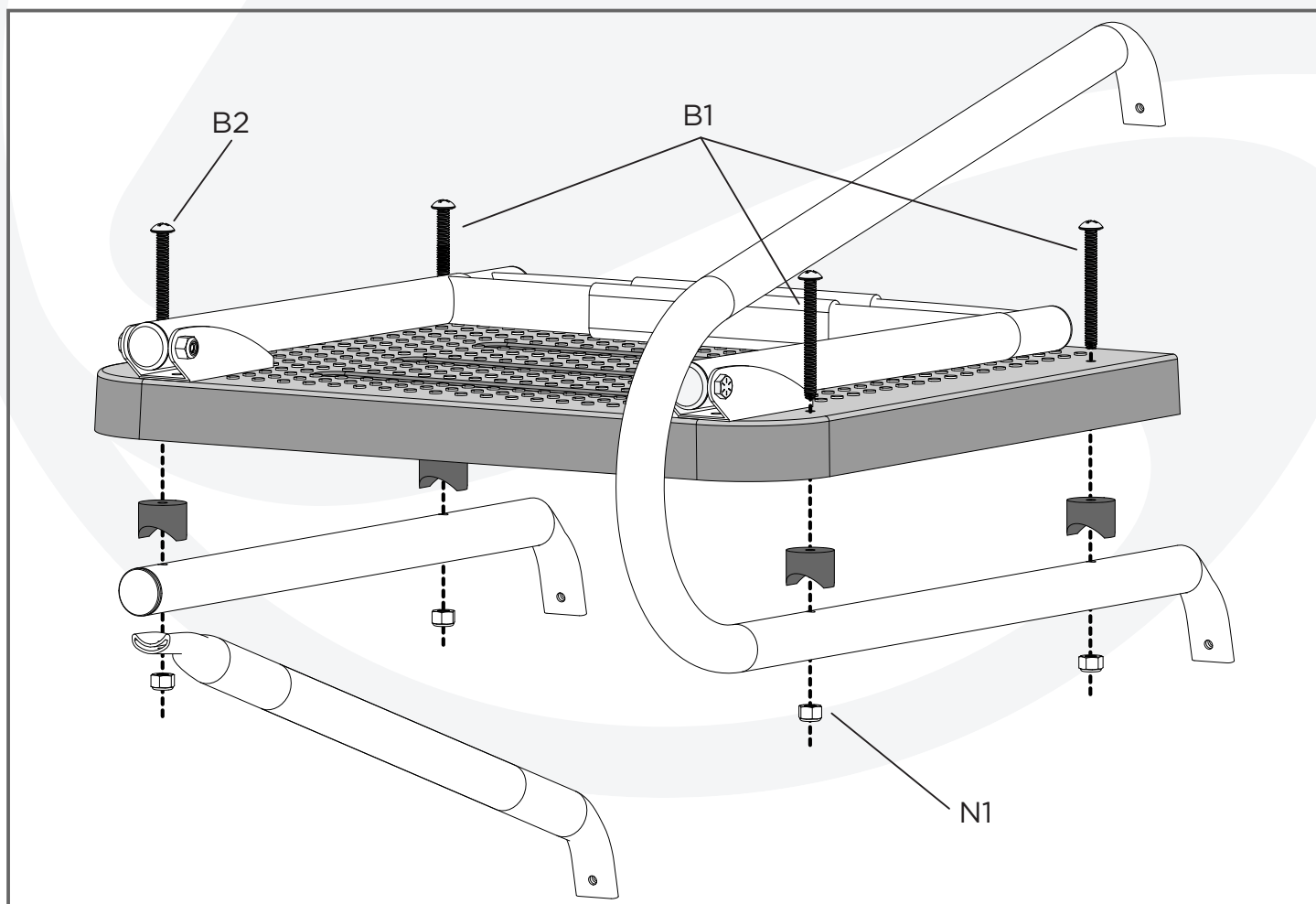



# **WARNING - ATTENTION**

Install Guide



## **WARNING**

Do not proceed with this installation guide unless you are part of the approved Legend Dealer Network. Please contact your nearest Legend Dealer to resolve any issues you may have.

LEGEND BOATS INC. IS NOT RESPONSIBLE FOR ANY DAMAGES THAT MAY INCUR FROM FOLLOWING THIS INSTALLATION GUIDE.

## **ATTENTION**

Ne poursuivez pas la consultation de ce guide d'installation si vous ne faites pas partie du réseau agréé de concessionnaires Legend. Veuillez contacter votre concessionnaire Legend le plus près pour résoudre tout problème qui pourrait survenir.

BATEAUX LEGEND INC. N'EST PAS RESPONSABLE DES DOMMAGES QUI POURRAIENT RÉSULTER DE L'APPLICATION DE CE GUIDE D'INSTALLATION.



# Swim Platform

Assembly & Installation Guide  
WB.SP.03

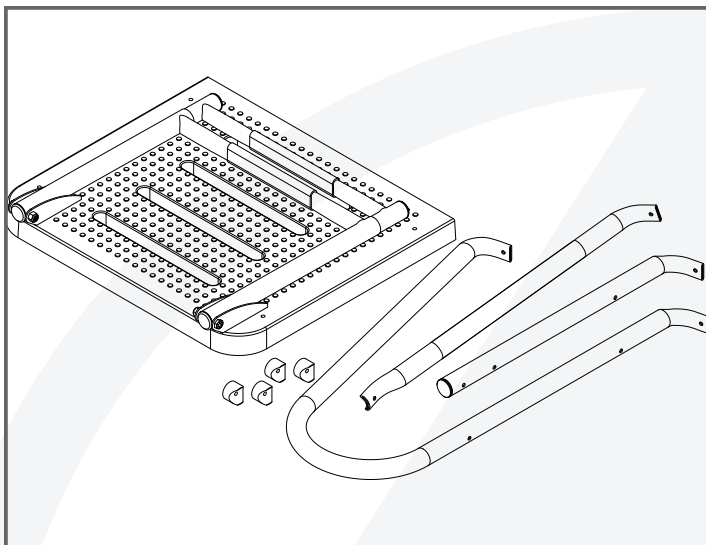

## STEP 1

Arrange all parts and hardware to begin assembling the Swim Platform.

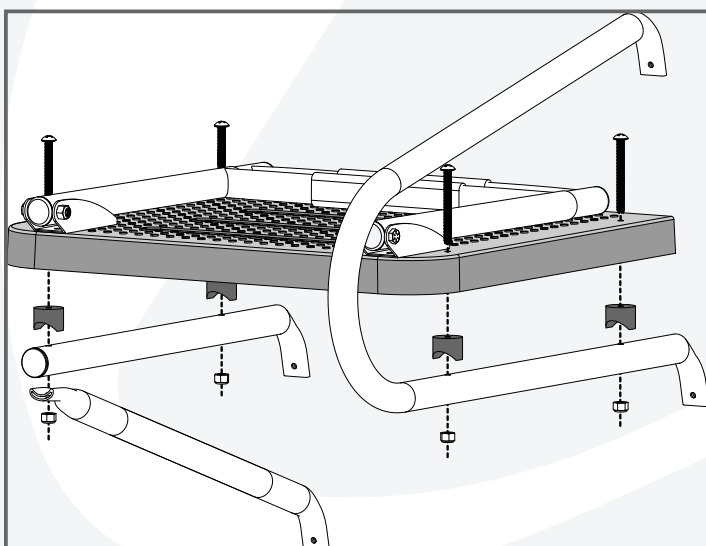

## STEP 2

Mount the Swim Platform onto the Handle Bar and Platform Supports.



## NOTE

Use the provided bumpers to mount the swim platform onto the frame.

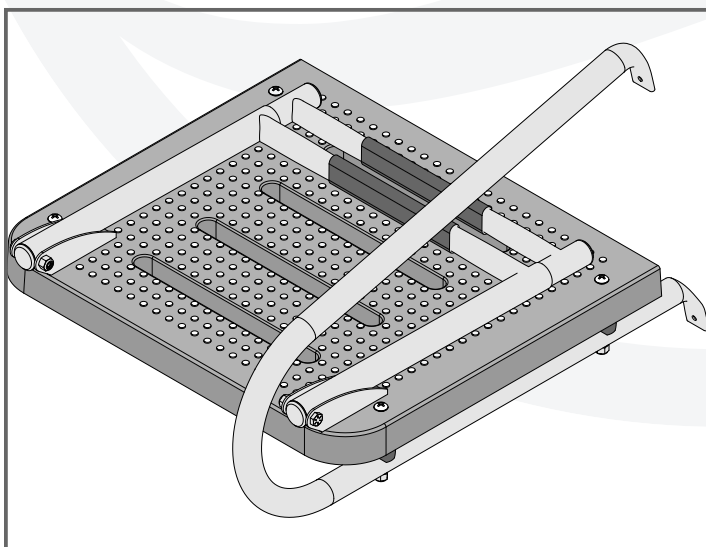

## STEP 3

Tighten all nuts prior to mounting to transom.



# Swim Platform

Assembly & Installation Guide  
WB.SP.03

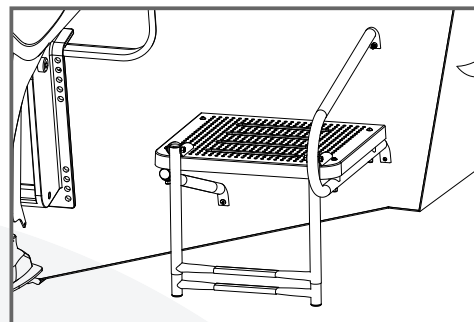

## ATTENTION

Do not mount swim platform before marking install location with Lead Rigger/Shop Foreman.

## HARDWARE REQUIRED

B3  x1

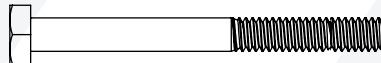
B4  x1

B5  x1

S1  x1

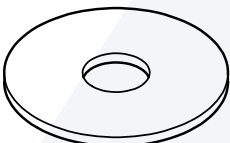
W2  x1

W3  x1

N1  x2

N2  x1

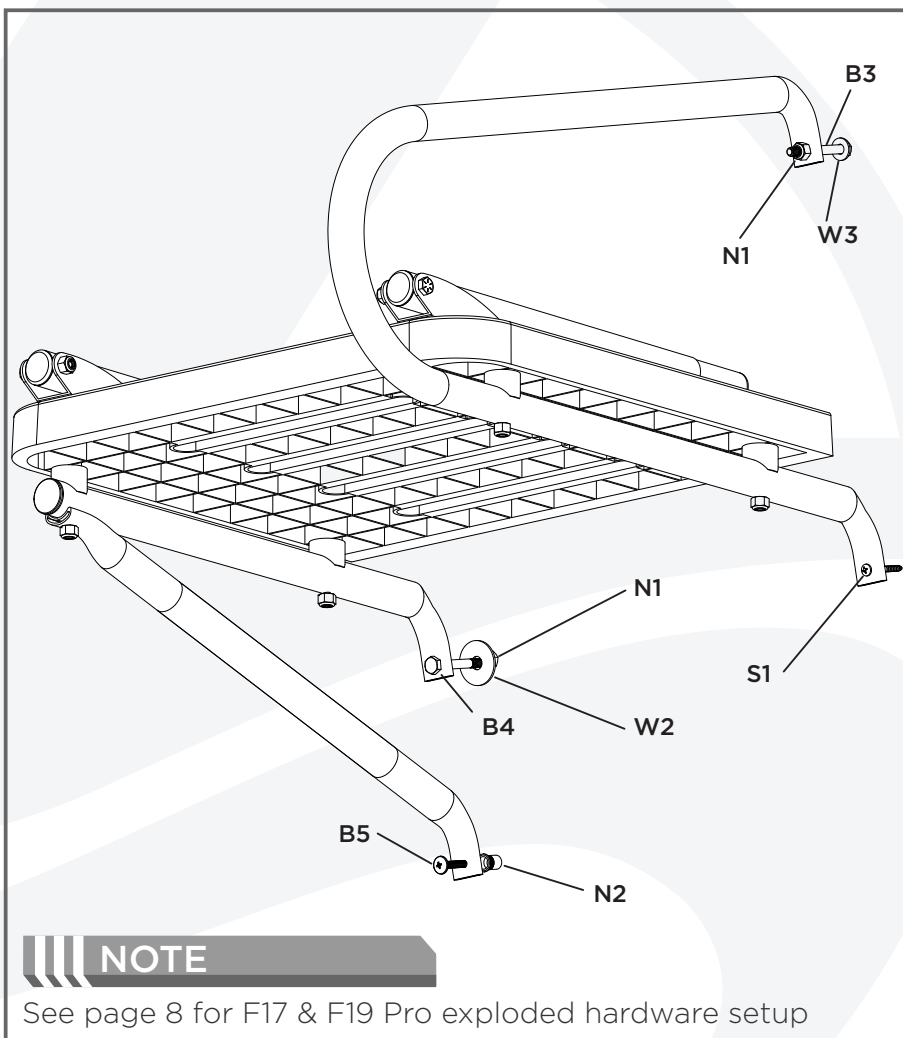

## NOTE

See page 8 for F17 & F19 Pro exploded hardware setup

## TOOLS REQUIRED

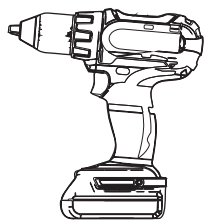

Drill



Nutsert  
Gun

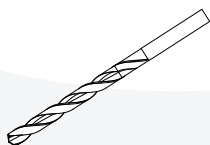

1/4" Drill Bit  
25/64" Drill Bit

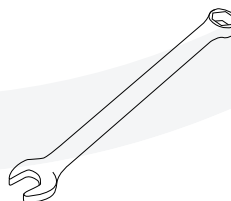

7/16" Wrench x2

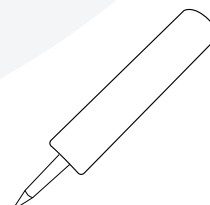

Silicone



# Swim Platform

Assembly & Installation Guide  
WB.SP.03

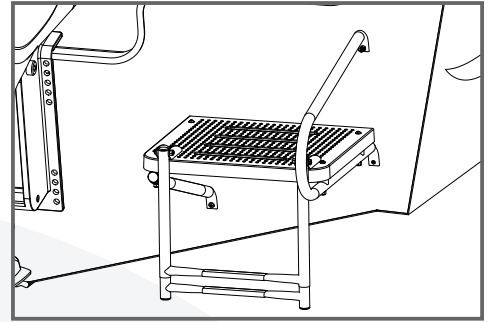

## STEP 1

Mark top hand rail mounting location and confirm with Lead Rigger/Shop Foreman. Do not mark hole location inside of the side wall.

### NOTE

Handrail mounting hole location is boat specific. Ensure the hole is close to the side wall and will accommodate the Bolt & Washer from the interior to bolt railing in place. If there is no side wall, ensure the Swim Platform does not extend past the transom (hatched area).

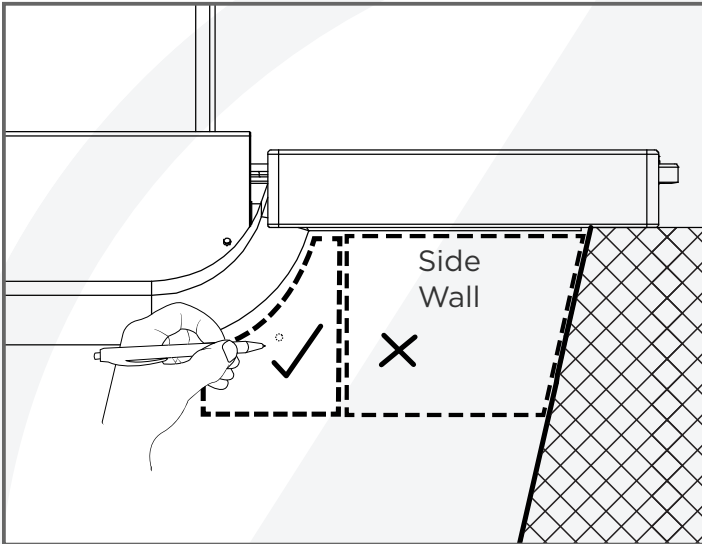

## STEP 2

Using a 1/4" drill bit, drill a pilot hole through the transom ensuring the hole is accessible from the inside of the Stern for Through Bolt access (B4).

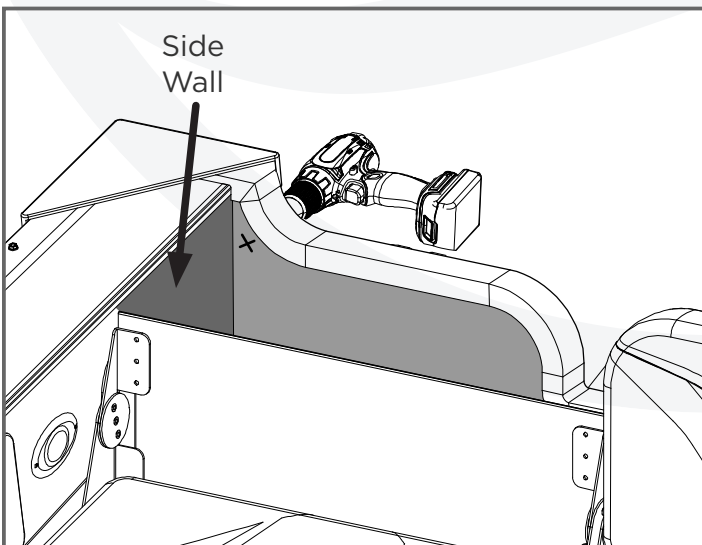
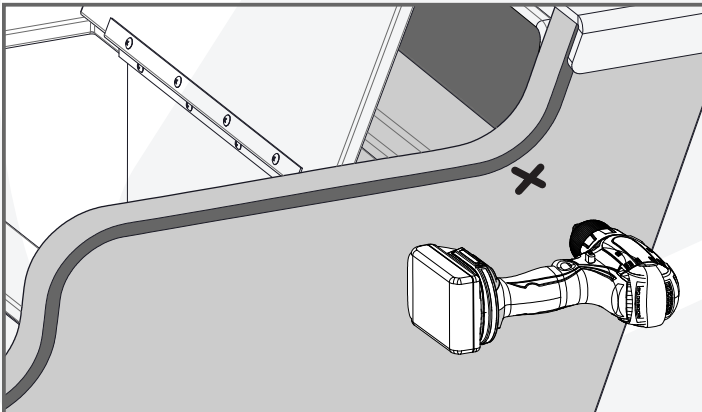



# Swim Platform

Assembly & Installation Guide  
WB.SP.03

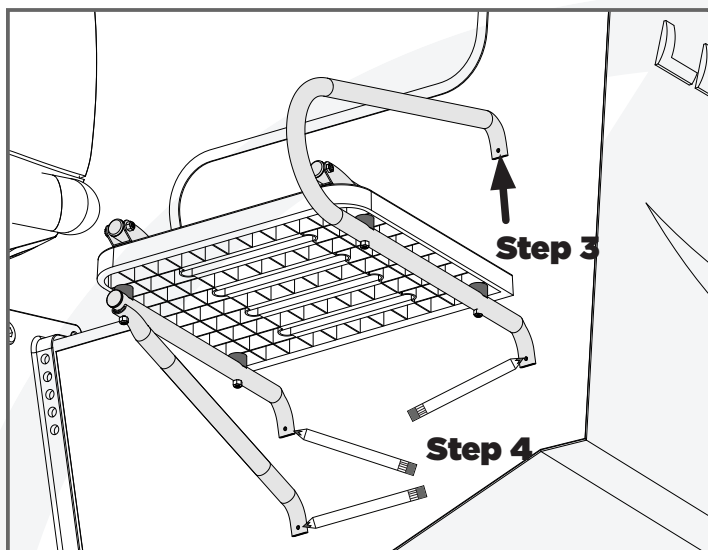

## STEP 3

Mount the swim platform onto the Hull and bolt the Hand Rail in place using the supplied hardware.

## STEP 4

With the assistance of a Lead Rigger/Shop Foreman, mark the remaining mounting locations of the Swim Platform.

Remove the Swim Platform to continue installation.

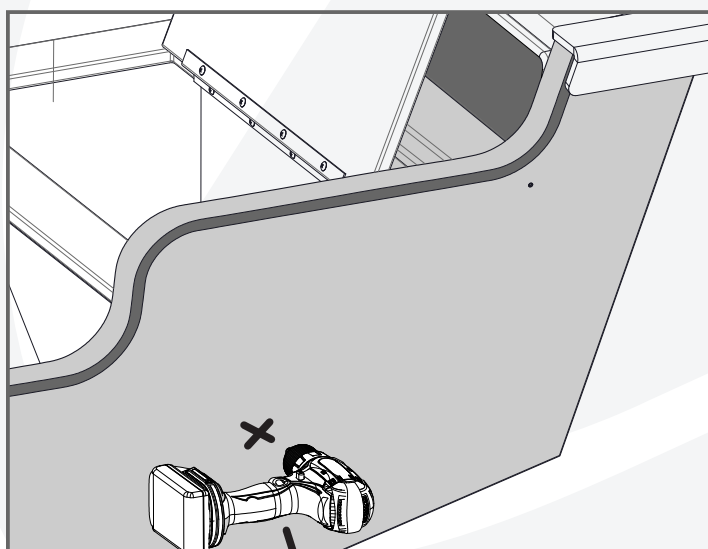

## STEP 5

***\*Read below attention before proceeding with step 5\**** Using a 1/4" drill bit, drill a pilot hole through the upper left marked hole of the transom ensuring the hole is accessible from the inside of the stern for through bolt access (B4).

## ATTENTION

Ensure no cords or fuel separator are at risk of being drilled into. Some models will require carpeting/flotation foam to be removed before drilling into the hull.

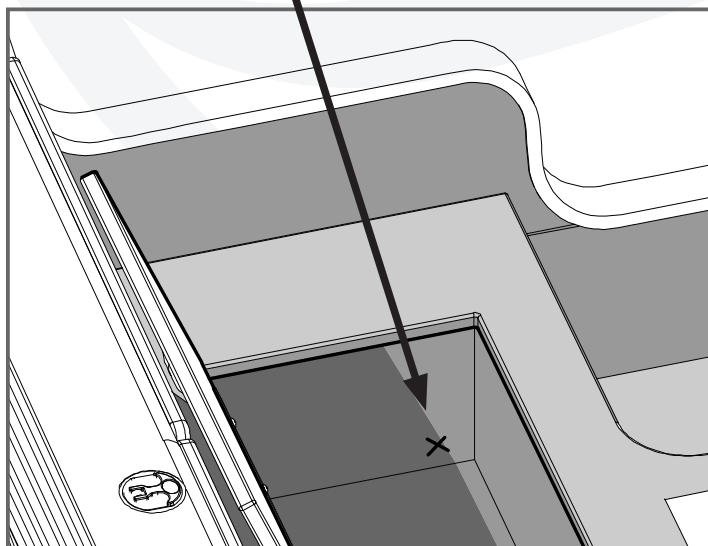

## ATTENTION

For F17 & F19 Pro Boats, using a 1/4" drill bit drill a pilot hole through the aluminum Hull only, to accommodate the Screw (S1).



# Swim Platform

Assembly & Installation Guide  
WB.SP.03

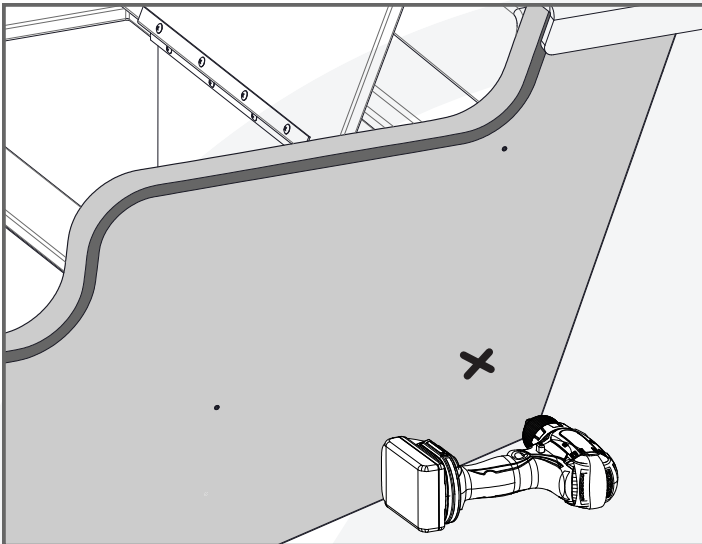

## STEP 6

Using a 1/4" drill bit, drill a pilot hole only through the Aluminum of the Hull to accommodate the Wood Screw (S1).

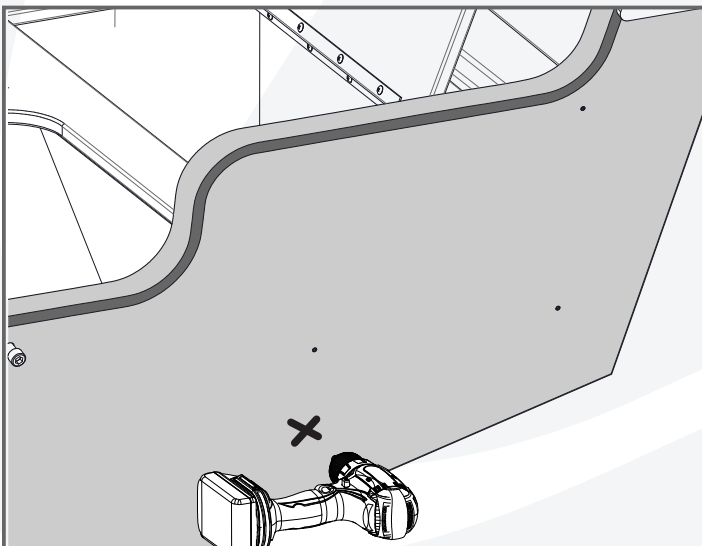

## STEP 7

Using a 25/64" drill bit, drill a pilot hole approximately 2" into the aluminum Hull to accommodate the Rivet Nut (N2).

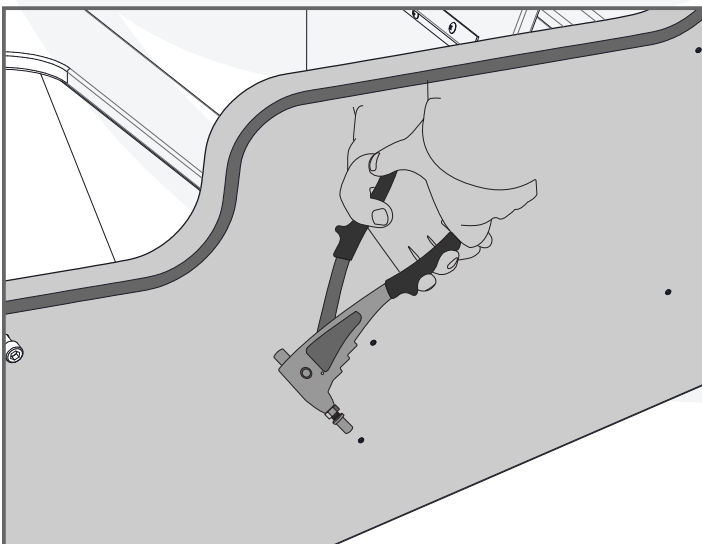

## STEP 8

Using a Nutsert Gun, insert the Nut into the bottom pilot hole and install in place (N2).



# Swim Platform

Assembly & Installation Guide  
WB.SP.03

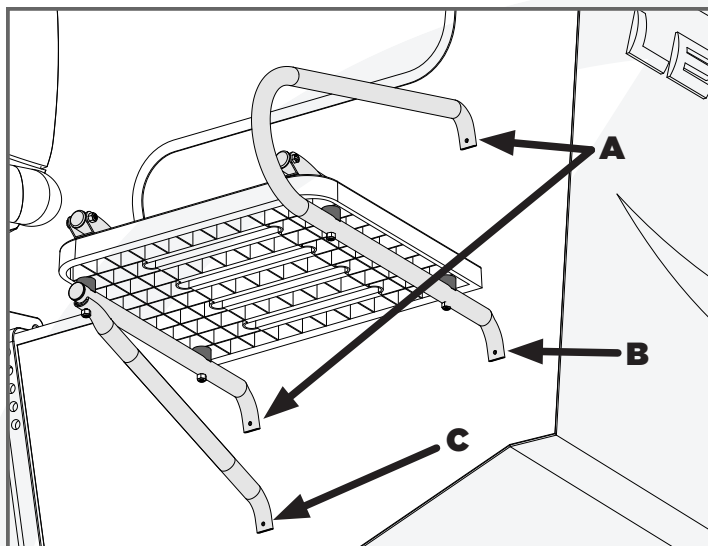

## STEP 9

Install the swim platform onto the Transom using the previously drilled pilot holes.

**A.** Mount the swim platform onto the Transom and bolt the Hand Rail and Platform Support using the supplied hardware.

**B.** Screw in the bottom Hand Rail using the (S1) Wood Screw.

**C.** Bolt the bottom Platform Support into the Rivet Nut using the (B5) Bolt.

## ATTENTION

Silicone all hardware before tightening to prevent any water damage.





# Swim Platform

Exploded View for F17 & F19 Pro  
WB.SP.03

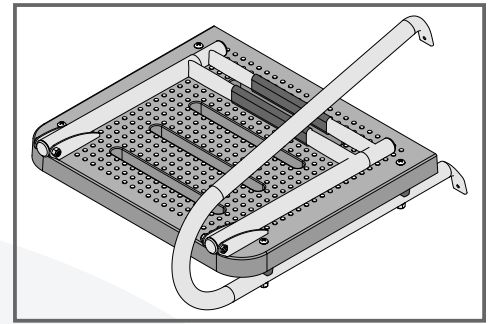

## ATTENTION

Do not mount swim platform before marking install location with Lead Rigger/Shop Foreman.

## HARDWARE REQUIRED

B3  x1

B5  x1

S1  x2

W3  x1

N1  x1

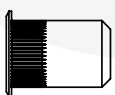
N2  x1

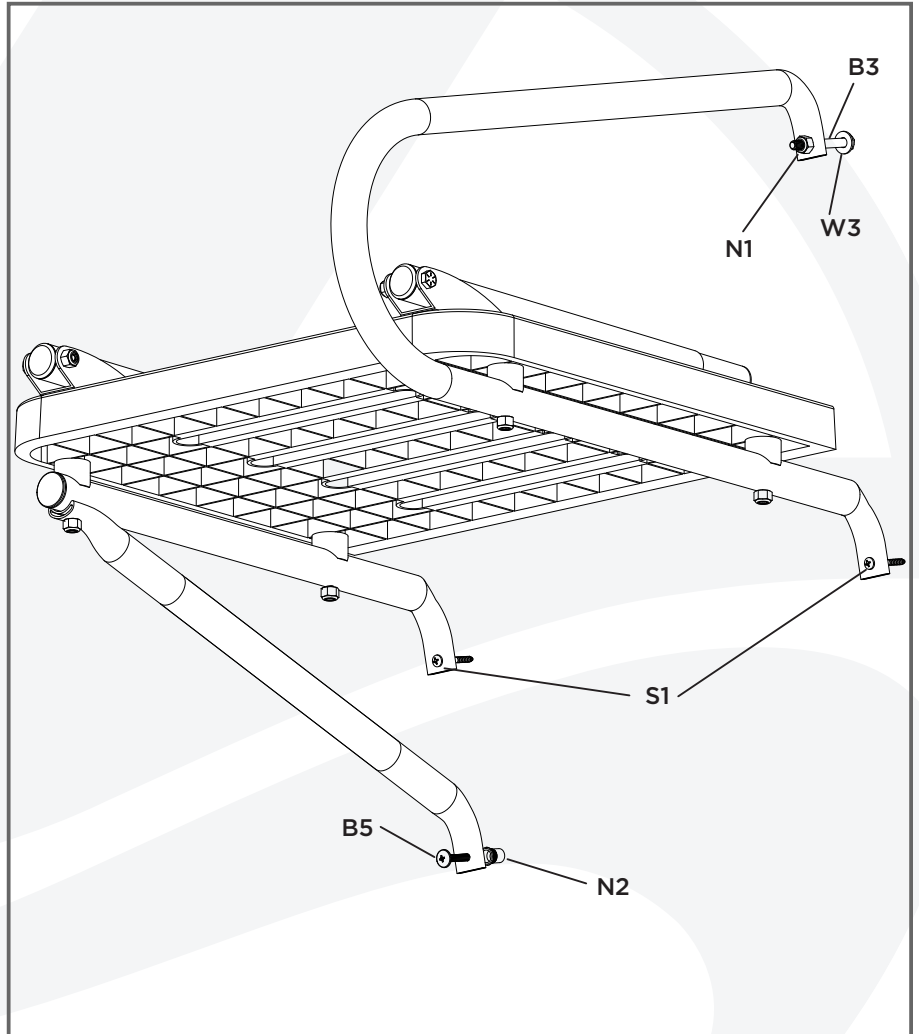

## TOOLS REQUIRED

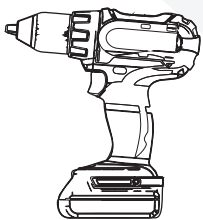

Drill

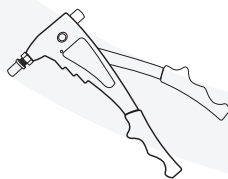

Nutsert  
Gun

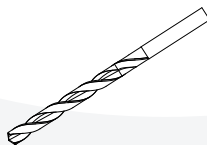

1/4" Drill Bit  
25/64" Drill Bit

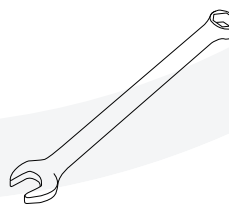

7/16" Wrench x2

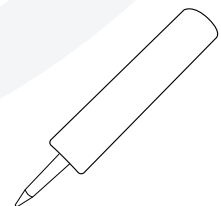

Silicone